

PE PICK OFF, CONNECTION MAIN CIRCUIT:  
SPRING-LOADED TERMINAL,



General technical data:		
product brandname		SIRIUS
Product designation		PE pick-up
Protection class IP		IP20
Degree of pollution		3
Installation altitude at height above sea level maximum	m	2 000
<b>Ambient temperature</b>		
• during transport	°C	-55 ... +80
• during storage	°C	-55 ... +80
• during operation	°C	-20 ... +60
Vibration resistance		f = 4 to 5.8 Hz; d = 15 mm; f = 5.8 to 500 Hz; a = 2 m / s <sup>2</sup> 10 cycles
Shock resistance		Semi-sinusoidal a = 6 m/s <sup>2</sup> at 10 ms; 3 pos. and 3 neg. Shock in all axes
Equipment marking acc. to DIN EN 61346-2		X
Equipment marking acc. to DIN 40719 extended according to IEC 204-2 acc. to IEC 750		X

Main circuit:

Operating current at AC at 400 V rated value	A	63
--	---	----







#### Installation/ mounting/ dimensions:

<b>Mounting type</b>		plug-in fixing
<b>Width</b>	mm	10
<b>Height</b>	mm	60
<b>Depth</b>	mm	35

#### Connections/ Terminals:

Type of electrical connection for main current circuit		spring-loaded terminals
<b>Wire stripping length for main contacts</b>	mm	10
Connectable conductor cross-section for main contacts for load-side outgoing feeder		
• solid	mm <sup>2</sup>	1.5 ... 10
• stranded	mm <sup>2</sup>	1.5 ... 10
• finely stranded with core end processing	mm <sup>2</sup>	1.5 ... 6
Type of connectable conductor cross-sections for main contacts for load-side outgoing feeder		
• solid		1.5 ... 10 mm <sup>2</sup>
• stranded		1.5 ... 10 mm <sup>2</sup>
• finely stranded with core end processing		1.5 ... 6 mm <sup>2</sup>
• finely stranded without core end processing		1.5 ... 6 mm <sup>2</sup>
Type of connectable conductor cross-sections at AWG conductors for main contacts for load-side outgoing feeder		16 ... 10, 1 x 8

#### Certificates/ approvals:

General Product Approval			EMC	Declaration of Conformity	Shipping Approval
 CSA	 UL		 C-Tick	 EG-Konf.	 BUREAU VERITAS

Shipping Approval					other
 DNV	 LRS	 PRS	 RINA	 RMRS	<a href="#">Environmental Confirmations</a>

other
<a href="#">Confirmation</a>

Safety related data:	
Protection against electrical shock	finger-safe

Further information
<b>Information- and Downloadcenter (Catalogs, Brochures,...)</b> <a href="http://www.siemens.com/industrial-controls/catalogs">http://www.siemens.com/industrial-controls/catalogs</a>
<b>Industry Mall (Online ordering system)</b> <a href="http://www.siemens.com/industrymall">http://www.siemens.com/industrymall</a>
<b>Cax online generator</b> <a href="http://support.automation.siemens.com/WW/CAXorder/default.aspx?lang=en&amp;mlfb=3RA6870-3AC">http://support.automation.siemens.com/WW/CAXorder/default.aspx?lang=en&amp;mlfb=3RA6870-3AC</a>
<b>Service&amp;Support (Manuals, Certificates, Characteristics, FAQs,...)</b> <a href="https://support.industry.siemens.com/cs/ww/en/ps/3RA6870-3AC">https://support.industry.siemens.com/cs/ww/en/ps/3RA6870-3AC</a>
<b>Image database (product images, 2D dimension drawings, 3D models, device circuit diagrams, EPLAN macros, ...)</b> <a href="http://www.automation.siemens.com/bilddb/cax_de.aspx?mlfb=3RA6870-3AC&amp;lang=en">http://www.automation.siemens.com/bilddb/cax_de.aspx?mlfb=3RA6870-3AC&amp;lang=en</a>

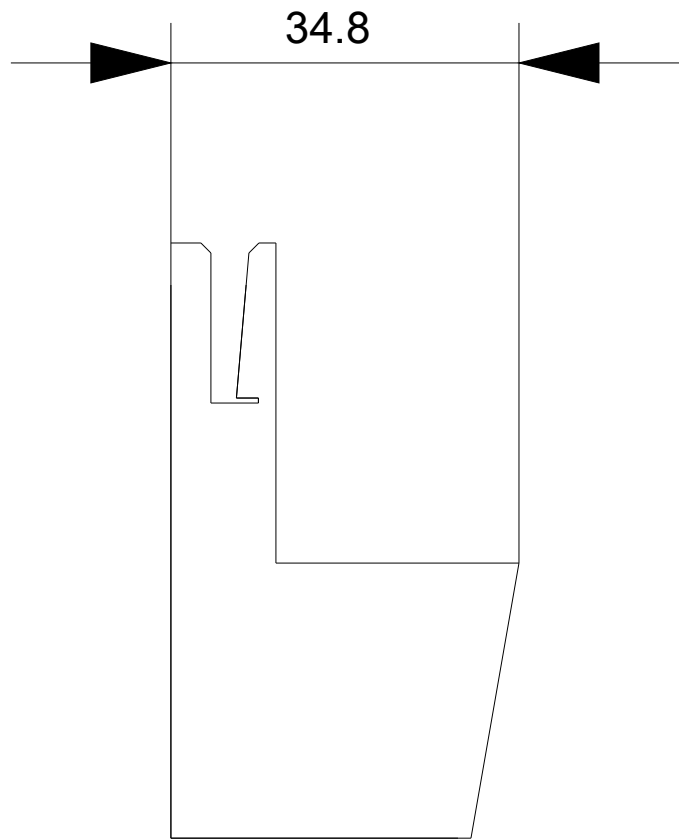
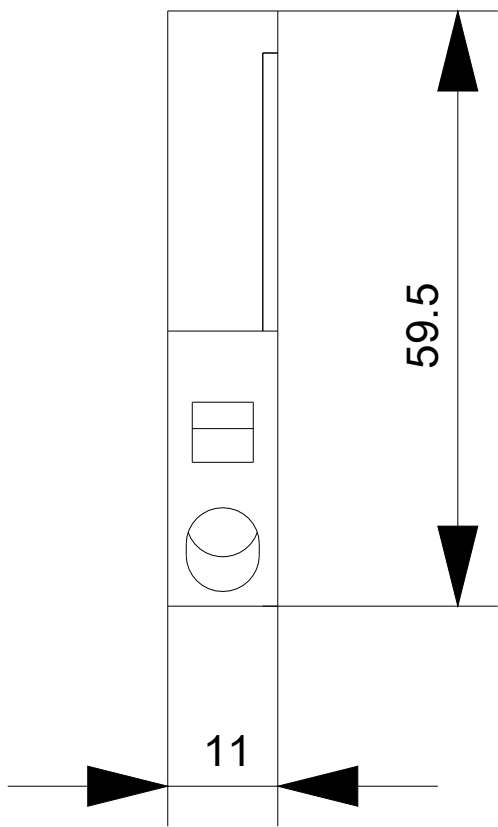

last modified:

07/01/2017